

ASSEMBLY INSTRUCTIONS

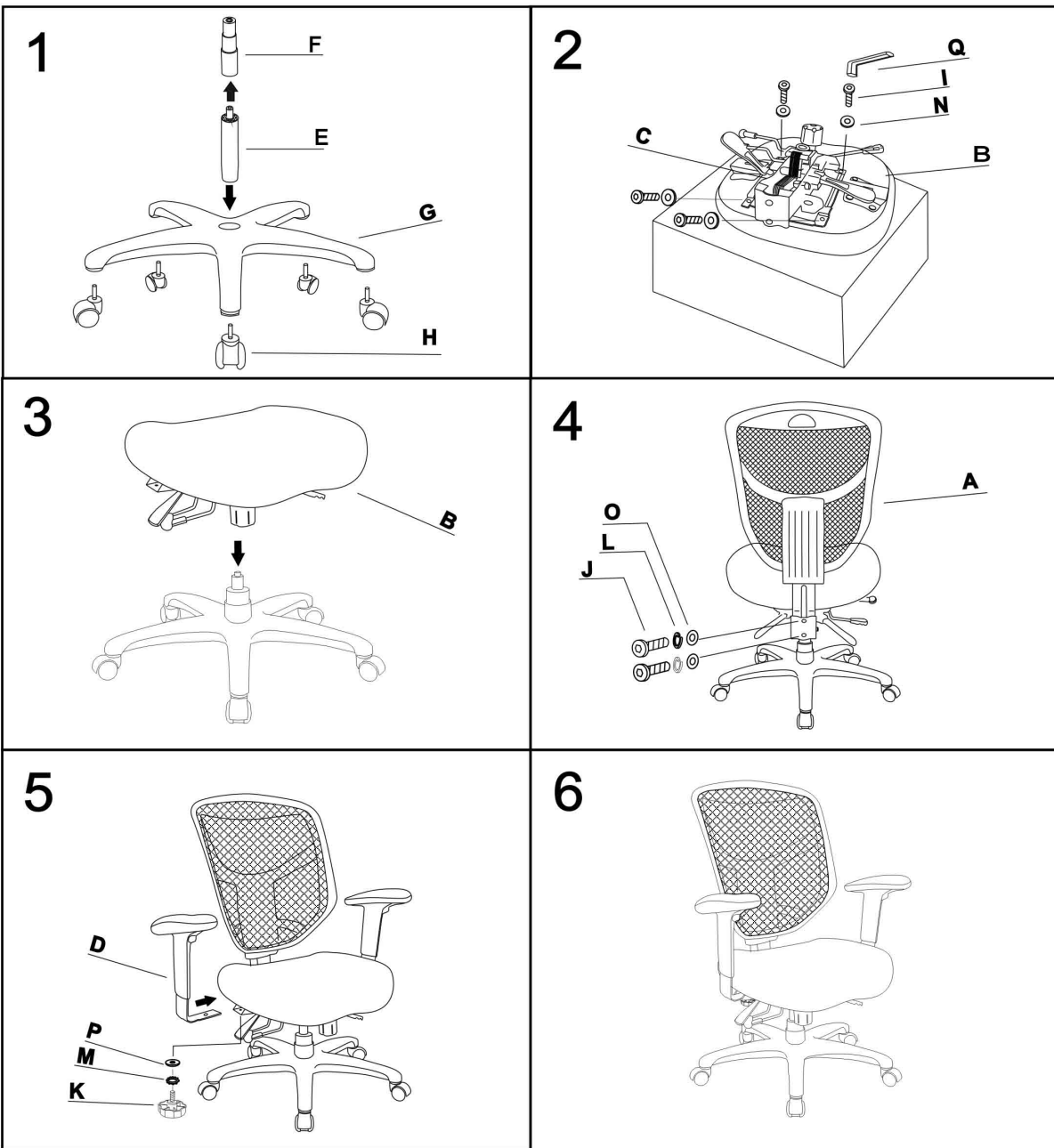

A BACK(1)	H CASTERS (5)
B SEAT(1)	I SEAT SCREW 1/4"*3/4" (5)
C MECHANISM (1)	J BACK SCREW M8*20 (3)
D ARMRESTS(2)	K ARM KNOB (2)
E SEAT POST (1)	L SPRING WASHER $\phi 8.3*\phi 12.5*2$ (3)
F SEAT POST COVER (1)	M GEAR WASHER $\phi 8.5*\phi 9.5*0.7$ (2)
G BASE(1)	N WASHER $\phi 8.5*19*1.5$ (5)
	O WASHER $\phi 9*22*2$ (3)
	P WASHER $\phi 8.5*19*2$ (2)
	Q ALLEN WRENCH(1)

Model: ALE-ER42ME10B
 Manufactured for/ Hecho para/ Fabriqué pour Alera®/USSCo,
 1 Parkway North, Suite 100, Deerfield, IL 60015 ©2009 USSCo
 Made in/Hecho en/ Fabriqué en China
 Product support and parts/ Ayuda del producto y partes/ Support
 technique pieces: 1-800-733-4000



OPERATION INSTRUCTIONS

ALE-ER42ME10B

A. Seat Height Adjustment

To raise the seat height, stand up from the chair while lifting the lever (A) under the right side of the seat. To lower the seat height, lift the lever (A) while sitting in the chair.

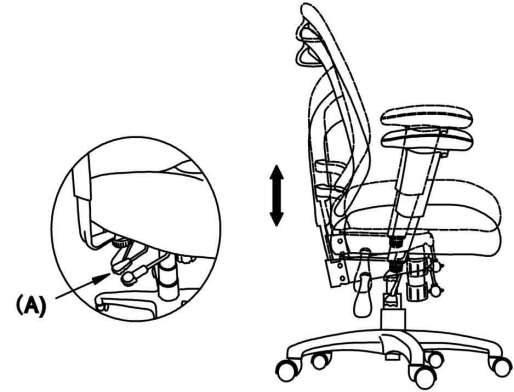

B. Seat Depth Adjustment

To adjust the seat depth, lift up the lever (B) to open it, and then lean against the back to move the seat forward. Pull the lever downward to the original position to lock the desirable seat depth.

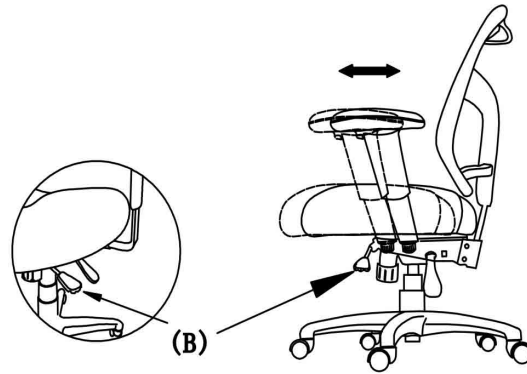

C. Back Angle Adjustment

To adjust the back angle, lift up the lever (C) to open it, and then lean against the back backward for satisfied position. Pull the lever down to the original position to lock it.



D. Seat Angle Adjustment

Push the lever (D) upward, and then lean against the back to cause the seat to tilt backwards. To lock the chair seat in the upright or vertical position, sit upright and push the lever (D) downward.

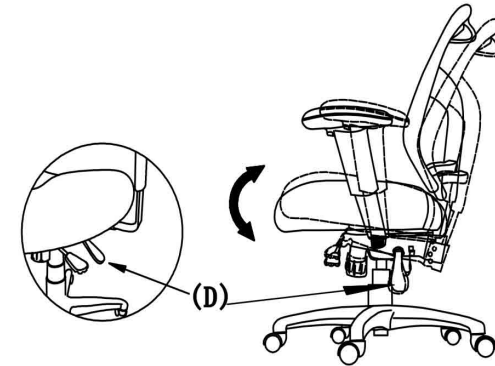

E. Forward Tilt Adjustment

Push the lever (D) upward to open it first, and then pull the lever (E) outward, the seat will tilt forward. Push the lever (E) inward and the lever (D) downward to lock the desired position.

F. Tilt Tension Adjustment

Knob underneath seat adjusts angle and tension according to the different weights and strength. To increase tension, turn knob (F) to the right (clockwise), while seated. To release tension (loosen), turn it to the left (counter-clockwise), while seated.

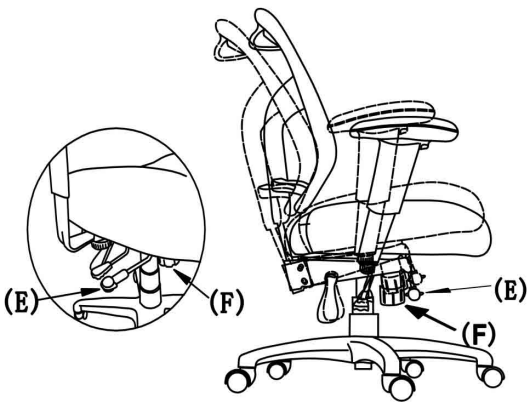

G. Arm Width Adjustment

To adjust the arm width, loosen the bolts (G) under the arm support and adjust to desirable placement on the chair.

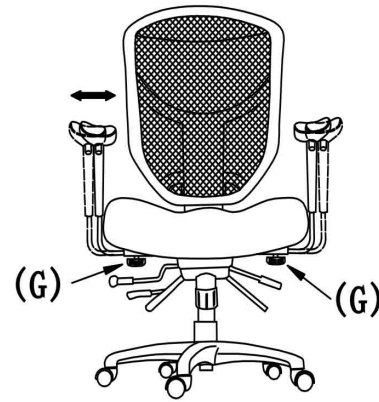

H. Arm Height Adjustment

To adjust the arm height, push the button (H) on the outside of each arm and move the arm up or down. Release the button to fix the height.

I. Back Height Adjustment

To raise the back pull up on the seat back until it clicks into the desired height. To lower the back, raise the seat back all the way up until tension is released and then lower all the way down. Raise back up to desired position.

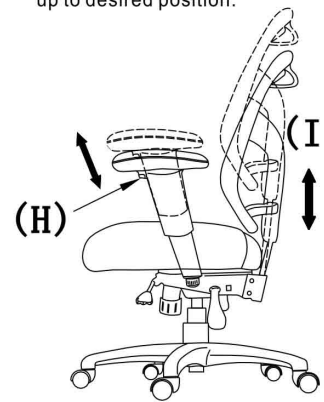

PREVENTIVE MAINTENANCE AND WARNINGS!

- USE THIS PRODUCT ONLY FOR SEATING ONE PERSON AT A TIME.
- DO NOT USE THIS CHAIR AS A STEP STOOL/ LADDER.
- DO NOT SIT ON ANY PART OF THE CHAIR EXCEPT THE SEAT.
- DO NOT USE CHAIR ON UNEVEN FLOOR SURFACES.
- DO NOT USE CHAIR UNLESS ALL BOLTS, SCREWS AND KNOBS ARE TIGHT. AT LEAST, EVERY SIX MONTHS, CHECK ALL BOLTS, SCREWS AND KNOBS TO MAKE SURE THEY ARE TIGHT.
- IF ANY PARTS ARE MISSING, BROKEN, DAMAGED OR WORN, STOP USE OF THE PRODUCT, UNTIL REPAIRS ARE MADE USING FACTORY AUTHORIZED PARTS.
- DISPOSE OF PACKAGING PROPERLY. PLASTIC BAG IS NOT A TOY. DO NOT USE PLASTIC BAG AS HEAD COVERING-IT MAY CAUSE SUFFOCATION.
- FAILURE TO FOLLOW THESE WARNINGS COULD RESULT IN SERIOUS INJURY.